

ELECTRIC FANS FOR VENTILATED EVAPORATORS

Series 101M/101T

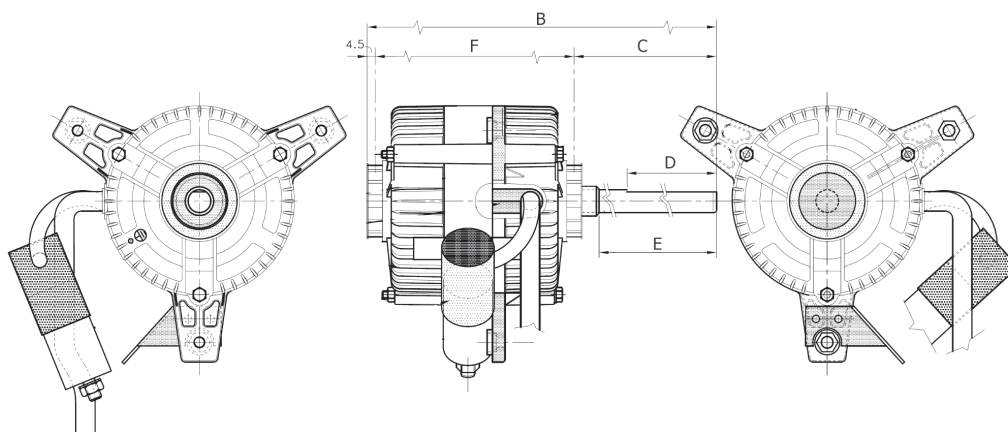
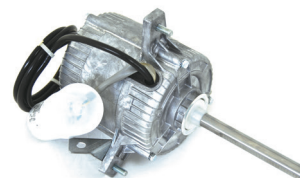

V/HZ	W OUTPUT	W ABS	A	rpm	B	C	D	E	F	CODE	€
230/50	120	245	1.0	1300	222	88	65	78	128	0402400*	150,00
230/50	150	270	1.3	1300	250	118	80	108	128	0402401*	170,00
380/50	145	235	0.45	1300	220	108	70	98	121	0402402	165,00
380/50	185	330	0.68	1300	220	88	70	78	128	0402403	175,00

* Rotation reversible by changing the electrical connection.

Note: 0402402 and 0402403 are going out of production and are only available while stocks last.

TECHNICAL FEATURES:

Single and three-phase motor, 4 poles, maximum usable power 185W, for fans up to a diameter of 400 mm.

Fitted on self-aligning bushings with lubricant reserve. CL "B", IP44. Motor casing diameter 106 mm

Fixing centres for the 3 holes at 120°, 157 mm

WIRING DIAGRAM, SINGLE-PHASE MODEL:

Common Blue Wire
Clockwise rotation Black Wire
Anticlockwise rotation Brown Wire

WARNING: If the black and brown wires are connected together, an irreparable electrical fault occurs.

MECHANICAL SEALS

PUMPS

FANS

MOTORS

INSULATION

EQUIPMENT

MOTOR SPARES

TOOL SPARES

SWITCHES