

SPARES FOR PELLET STOVES AND FIREPLACES

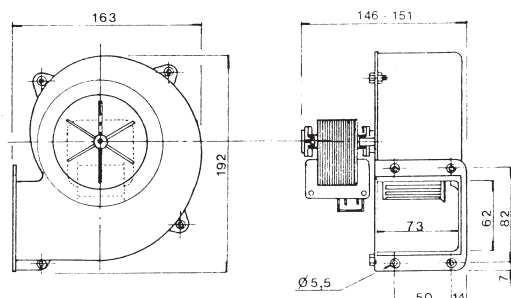

Centrifugal Fans



CHARACTERISTICS: MODEL 0402206

- Single-phase motor, 220/240V 50Hz suitable for continuous service.
- Scroll housing and fan in black nylon, motor support in galvanised plating, fan dia. 100 mm, intake opening dia. 82 mm.

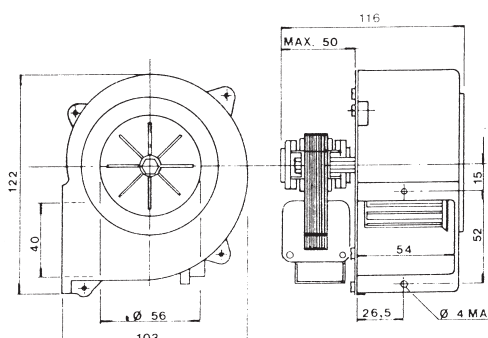

CHARACTERISTICS: MODEL 0402210

- Single-phase 2-pole induction motor, 220/240V 50 Hz suitable for continuous service.
- Plate dimensions 61x 61 m/m.
- Die-cast aluminium scroll housing.
- Nylon fan, dia. 70 mm.

W	A	m³/h	CODE	€
17	0.15	90	0402210	61,00
60	0.43	300	0402206	102,26
60	0.43	300	0402211*	98,85

*Aluminium scroll housing of the same dimensions as code 0402206
Packages: Single items Capacitor included

102,26

GENERAL CHARACTERISTICS:

- Class F insulation
- Self-lubricating and self-aligning bushings, with lubricant reserve.
- Trip switch protection with impedance.
- Electrical connection using Faston 6,35 male contacts attached to the coil.

USES:

Heating, refrigeration, and air conditioning systems, driers, extractors for hoods, fume extraction in general, industrial uses, etc.

MECHANICAL SEALS

PUMPS

FANS

MOTORS

INSULATION

EQUIPMENT

MOTOR SPARES

TOOL SPARES

SWITCHES