

CENTRIFUGAL TOWER - HORIZONTAL FLOW

ROOF-CM Series

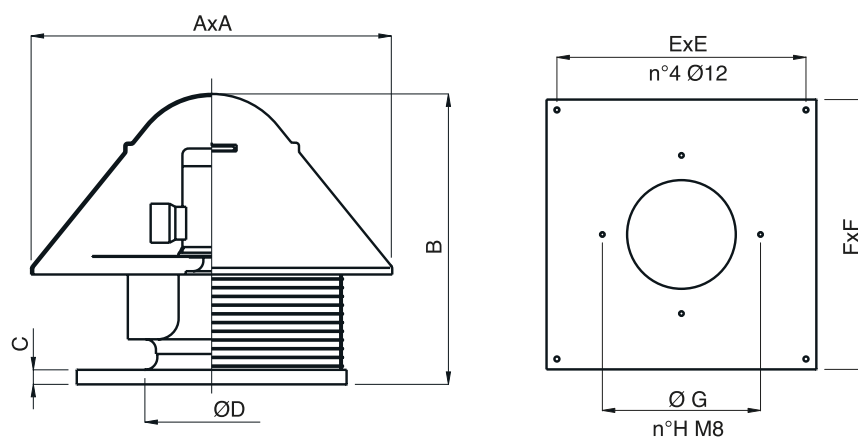

MOD.	A	B	C	Ø D	E	F	Ø G	N°H	kg
31	570	490	30	280	360	400	310	3	16
35	670	600	30	300	450	500	330	3	24
40	840	700	30	350	600	650	382	4	36
45	840	730	30	400	600	650	432	4	43
50	1000	840	35	450	710	760	485	5	54
56	1000	880	35	470	710	760	535	5	56
63	1200	980	35	550	870	930	580	6	74
71	1200	1030	35	600	870	930	634	7	105

APPLICATIONS

This series is designed for installation on the roof, for ducted and direct extraction, from civil, commercial and industrial buildings, such as: offices, restaurants, hotels, shopping malls, factory buildings, machine rooms, etc.

TECHNICAL SPECIFICATIONS

- Air conveyed: clean or slightly dusty.
- Temperature of air conveyed: -20°C / +80°C.
- Power supply:
 - Three-phase version (T) 400V - 50Hz
 - Single-phase version (M) 230V - 50Hz
- Only works as an extractor.