

# COOLING FAN FOR MOTORS IN DIE-CAST ALUMINIUM

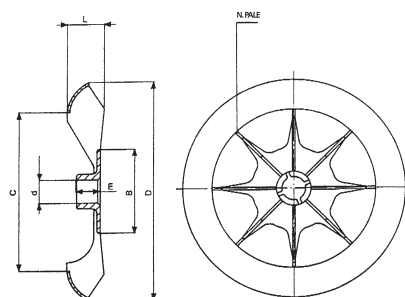

MOTOR SIZE	B	C	D	d	E	L	N° BLADES	📦 pcs	CODE	€/pc
MEC 63	48	82	115	14	14	20	8	12	<b>3308080</b>	<b>3,83</b>
MEC 71	50	96	132	14	14	22	8	12	<b>3308081</b>	<b>3,97</b>
MEC 80	55	112	147	19	16	24	8	6	<b>3308082</b>	<b>4,47</b>
MEC 90	60	126	166	24	19	27	8	6	<b>3308083</b>	<b>5,98</b>
MEC 100	70	145	184	28	21	30	8	6	<b>3308084</b>	<b>8,65</b>

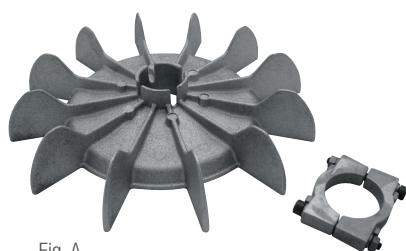

Fig. A

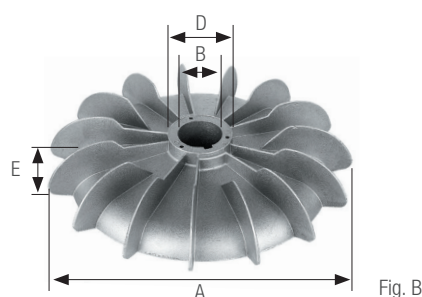

Fig. B

FIG	MOTOR SIZE	A EXT.	B INT.	D	E	N° blades	📦 pcs	CODE	€/pc
A	MEC 63	108	14	18.5	20	10	12	<b>3308008</b>	<b>5,11</b>
A	MEC 71	128	14	22	23	12	12	<b>3308009</b>	<b>5,43</b>
A	MEC 80	142	19	28	28.5	12	6	<b>3308010</b>	<b>5,87</b>
A	MEC 90	161	24	33	29.5	12	6	<b>3308011</b>	<b>7,85</b>
A	MEC 100	178	28	37	33	12	6	<b>3308012</b>	<b>8,45</b>
A	MEC 112	192	28	37	36	12	6	<b>3308013</b>	<b>10,27</b>
A	MEC 132	238	37.5	50	48	12	6	<b>3308014</b>	<b>14,34</b>
A	MEC 160	292	44	49	53	12	3	<b>3308015</b>	<b>25,20</b>
B	MEC 180	334	50	70	67	15	1	<b>3308016</b>	<b>148,00</b>
B	MEC 200	372	60/65	90	75	15	1	<b>3308017</b>	<b>172,00</b>
B	MEC 225	411	60	90	76	14	1	<b>3308018</b>	<b>174,00</b>
B	MEC 250	460	70	95	85	15	1	<b>3308019</b>	<b>233,00</b>
B	MEC 280	530	80	120	100	16	1	<b>3308020</b>	<b>391,00</b>
B	MEC 315	580	90	140	115	16	1	<b>3308021</b>	<b>496,00</b>
B	MEC 355	660	-	160	120	17	1	<b>3308087</b>	<b>1088,00</b>

Figures A and B shown on this page are purely indicative, the dimensions indication in the table apply.

The fans shown in Fig. B are supplied with a 10 mm supply hole. Dimension B in the table indicates the max. diameter of the shaft that can be made on a lathe.